



LIVE THE
FRENCH WAY
IN ABU DHABI



SOFITEL
HOTELS & RESORTS

أبوظبي كورنيش
ABU DHABI CORNICHE



ACCESSIBILITY

FROM SOFITEL BASED IN CITY CENTER

From	Time	By
Abu Dhabi International Airport	29 min	Car
Abu Dhabi National Exhibition Centre	17 min	Car
Louvre Museum *	14 min	Car
Ferrari World/ Yas Mall/ Yas Waterworld*	25 min	Car
Saadiyat Island *	16 min	Car
Marina Mall*	19 min	Car
Dubai International Airport	1 h 40 min	Car
The Mall, WTC	10 min	walk
Corniche Beach*	8 min 21 min	Car walk

* COMPLIMENTARY SHUTTLE OFFERED



DISCOVER NEARBY ATTRACTIONS

Louvre Museum
& Saadiyat
Cultural District

Old Souk

Marina Mall &
Heritage Village

Qasr Al Watan

Emirates Palace

Qasr Al Hosn

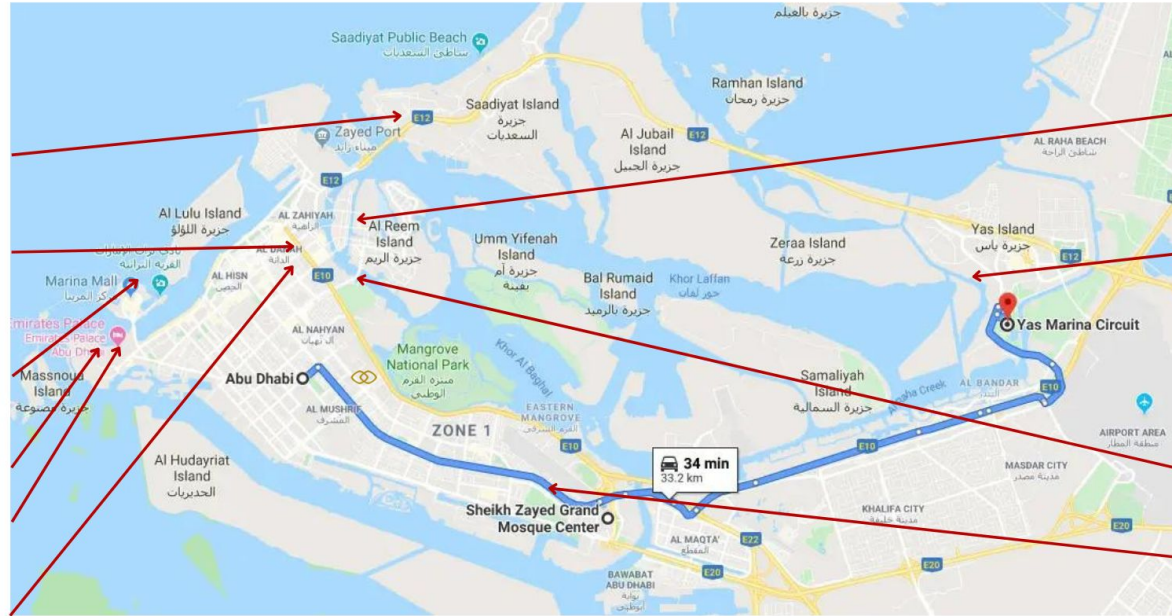

Galleria Mall

Yas Waterworld,
Ferrari World &
Yas Mall

Abu Dhabi Mall

Sheikh Zayed
Grand Mosque

UNITED ARAB EMIRATES



WHAT TO DO IN ABU DHABI?

SHEIK ZAYED GRAND MOSQUE

The mosque is one of Abu Dhabi's most recognizable landmarks. Clad in marble, this stunning work of art is able to hold 40,000 worshippers and is the biggest mosque in the UAE. Free guided tours are also available.

FERRARI WORLD

The only Ferrari theme park in the world, Ferrari World is filled with exciting rides including the world's fastest roller coaster.

DESERT SAFARI

For all nature-lovers, enjoy a one of a kind adventure in the heart of the desert. Experience camel-riding and bonfires with sand dunes all around.



WHAT TO DO IN ABU DHABI?

MANARAT AL SAADIYAT

Manarat Al Saadiyat is an all purpose art and cultural centre with multiple gallery spaces. It offers guests the opportunity to discover famous collections from international artists as well as culturally rich exhibits from local artists.

HERITAGE VILLAGE

The village is a replica of a traditional desert village from before the discovery of oil in the Emirates. It takes you to a historical tour of the Emirati life including display of traditional day-to-day objects.

YAS ISLAND

A must-visit, this man-made island is a multi-purpose leisure center with shopping and entertainment facilities including Yas Mall, Yas Waterworld and Yas Marina Circuit.





FITEL
S & RESORTS
فيل
شارج
SHARJH CORNICHE

Superior Room City View

280 ROOMS AND SUITES

Type	Number	Size	View	Bed
Superior Room	99	42 sqm	City & Saadiyat Island	One king bed or two twin beds
Luxury Room	94	42 sqm	Sea View	One king bed or two twin beds
Luxury Room Club Sofitel	40	43 sqm	Sea View – City & Saadiyat Island	One king bed or two twin beds
Prestige Suite	24	78 sqm	Sea View – City & Saadiyat Island	One king bed
Opera Suite	19	85 sqm	Sea View – City & Saadiyat Island	One king bed
Imperial Suite	4	125 sqm	Sea View	One king bed



ROOM TYPES



Imperial Suite 125 sqm



Prestige Suite 78 sqm



Superior Twin 42 sqm



Luxury Club Room 43 sqm



Opera Suite 85 sqm

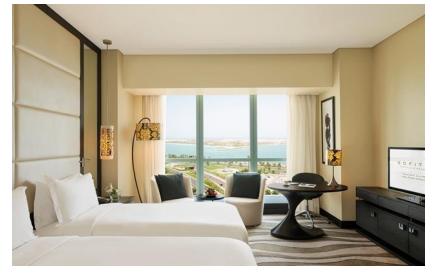

Luxury Twin 42 sqm

CLUB MILLÉSIME

Executive lounge at the top floor for
suite and club room bookings.
Breakfast and all day refreshments
are served

Le Goûter – 3:00 pm to 5:00 pm

Apéro Chic – 6:00 pm to 8:00 pm



CULINARY SELECTIONS

From	Cuisine	Timing
Corniche All Day Dining	All Day Dining Restaurant	6:00 am to 10:30 pm
Silk & Spice	Thai Restaurant and Bar	12:00 pm to 3:00 pm 6:30 pm - 10:30 pm
Grills @ Chill'O	Arabic and Mediterranean cuisines by the pool	12:00 pm to 1:00 pm (Weekdays) 12:00 pm to 2:00 am (Weekends)
Jazz N' Fizz	Bar overlooking the City	4:00 pm to 2:00 am
Le Cafe	Lounge Cafe	7:00 am to 9:00 pm
French Bakery Corner	Bakery	6:00 am to 9:00 pm



CULINARY SELECTION



SWIMMING POOL



The free-form pool offers amazing view of the
Corniche and the Arabian Gulf

Opening from 7:00 am to 9:00 pm





SOFITEL
HOTELS & RESORTS
أبوظبي كورنيش
ABU DHABI CORNICHE

Crystal Ballroom

FLOOR PLAN LEVEL 2

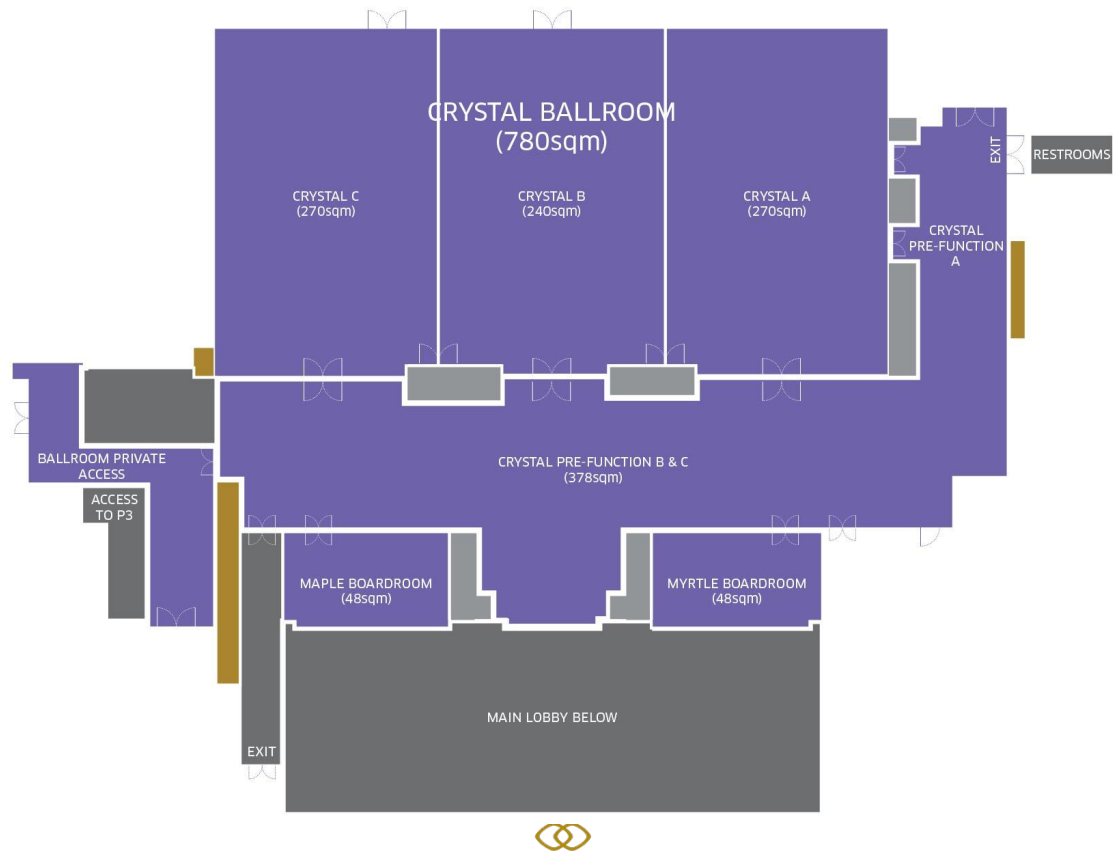



BRIDAL ROOM



CRYSTAL WEDDING SET UP



FLOOR PLAN LEVEL 3

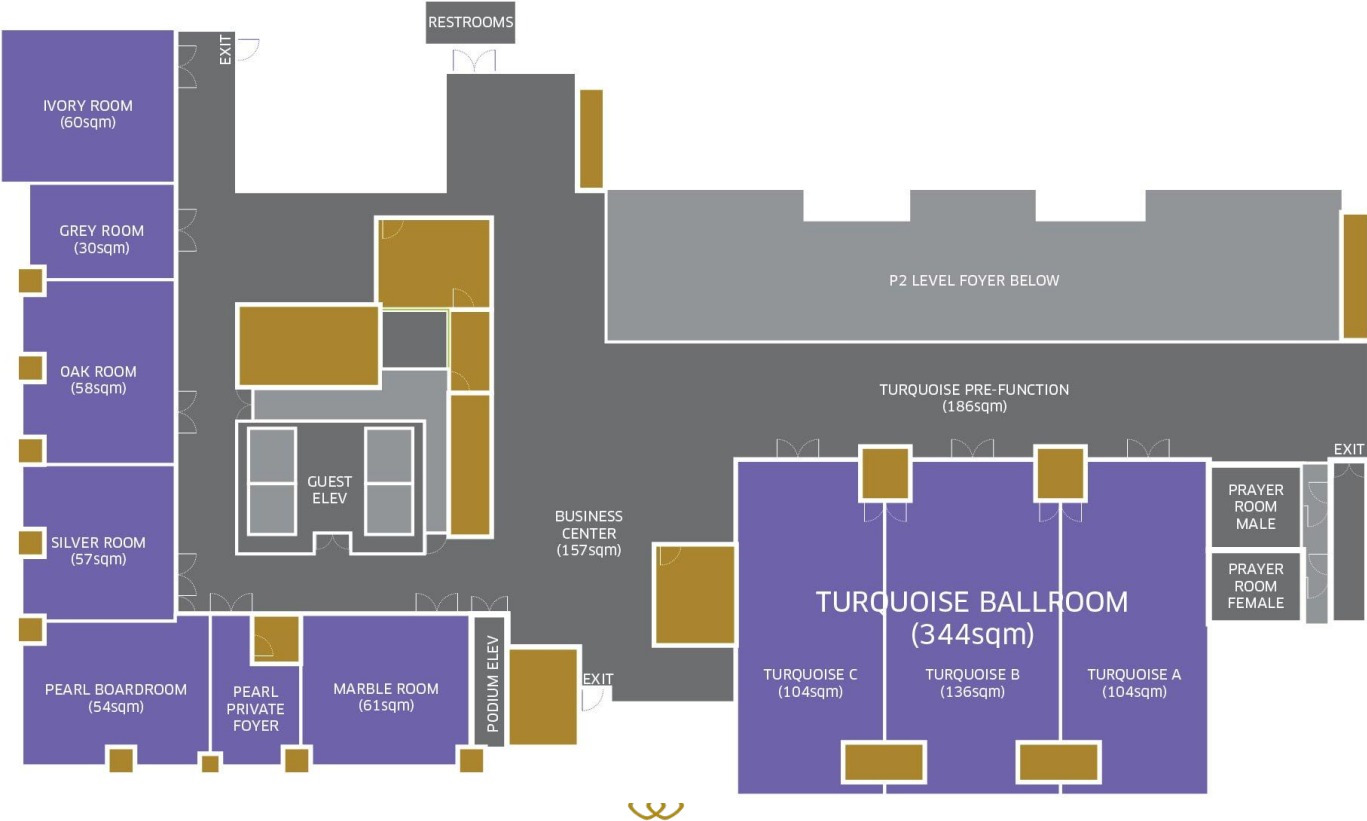

TURQUOISE BALLROOM



TURQUOISE WEDDING SET UP



IVORY MEETING ROOM



MARBLE MEETING ROOM



PEARL BOARDROOM



CAPACITY CHART

MEETING ROOMS	SURFACE M ²	L x W M	HEIGHT M	CLASSROOM	THEATER	U-SHAPE	BOARDROOM	CABARET	DINNER	COCKTAIL
CRYSTAL BALLROOM	780	39 X 20	6	315	750	117	105	350	600	800
CRYSTAL A	270	20 X 13.5	6	108	180	45	42	84	200	300
CRYSTAL B	240	20 X 12	6	108	180	45	42	70	150	300
CRYSTAL C	270	20 X 13.5	6	108	180	45	42	84	200	300
CRYSTAL (A+B) OR (B+C)	510	25.5 X 20	6	180	360	75	58	210	300	600
CRYSTAL PRE-FUNCTION	378	42 X 9	9.5							400
MAPLE BOARDROOM	48	9.5 X 5	2.8				15			
BRIDAL SUITE	48	9.5 X 5	2.8			15				
PEARL BOARDROOM with PRIVATE FOYER	54	9 X 6	3.5				16			
TURQUOISE MEETING ROOM	344	21.5 X 16	3.5	135	250	60	42	120	180	300
TURQUOISE A	104	16 X 6.5	3.5	36	50	30	24	35	50	70
TURQUOISE B	136	16 X 8.5	3.5	54	70	33	24	42	60	80
TURQUOISE C	104	16 X 6.5	3.5	36	50	30	24	35	50	70
TURQUOISE (A+B) OR (B+C)	240	16 X 15	3.5	63	120	42	36	70	110	100
MARBLE ROOM	61	7.35 X 8.34	3.5	18	30	15	14	21	20	
SILVER ROOM	57	7.8 X 7.3	3.3	18	30	15	14	21	20	
OAK ROOM	58	9 X 6.4	3.3	18	30	15	14	21	20	
GREY ROOM	30	4.3 X 7	3.3	9	16	10		12	10	
IVORY ROOM	60	8.55 X 7	3.5	24	40	18	14	18	30	
TURQUOISE PRE-FUNCTION	186	31 X 6	3.5							
BUSINESS CENTRE - COFFEE LOUNGE -LIBRARY INTERNET AREA	157		3.5							



Turquoise Ballroom Pre Function Area

S O F I T E L
HOTELS & RESORTS

أبوظبي كورنيش
ABU DHABI CORNICHE

Corniche Road East, Capital Plaza Complex - 44966 ABU DHABI UNITED ARAB EMIRATES

TEL.:+ 971(0) 2813 7777 – H7507@SOFITEL.COM WWW.SOFITELABUDHABICORNICHE.COM

